



WWW.RESUNSOLAR.COM

## RS6S330P

RS6S-P is a robust solar module with 72 solar cells. These modules can be used for on-grid solar applications. Our meticulous design and production techniques ensure a high-yield, long-term performance for every module produced. Our rigorous quality control and in-house testing facilities guarantee Resun Solar's modules meet the highest quality standards possible.

RS6S-P have five instead of three bus bars, which allows more efficient current collection and can also improve long term performance.

The RS6S-P cells use a novel junction formation technology which is standard in semiconductor manufacturing. This allows for improved minority carrier lifetimes and a very tight distribution of cell performance in manufacturing. RS6S-P cells are PID free and further increase the cell efficiency allowing to increase the average module power distribution.



**72 Cells**  
Poly-crystalline

**330W**  
Power output

**17.01%**  
The Highest Efficiency

**0~+5W**  
Tolerance



**High module conversion efficiency (up to 17.01%), through superior manufacturing technology**



**Guaranteed 0~+5W positive power output tolerance ensures high reliability**



**Anti-reflective, hydrophobic coating improves light absorption and reduces surface dust**



**Excellent performance under low light environments (mornings, evenings and cloudy days)**



**Suitable for harsh environments, such as coasts, deserts and lakes. Withstand high level of wind loads (2400pa) and snow loads (5400pa)**

### 0.5% Annual Degradation over 30 years

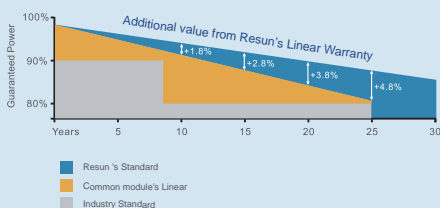

**LINEAR PERFORMANCE WARRANTY**  
12 year Product Warranty / 30 year Linear Power Warranty

### Full range of products and certification systems

ISO 9001 TUV PID-FREE CE IEC61215/61730/61701/62716



# RS6S-P



GLOBAL PROFESSIONAL PV PRODUCTS INTERGRATED SOLUTIONS SUPPLIER

Dimension of PV Modules Unit: mm

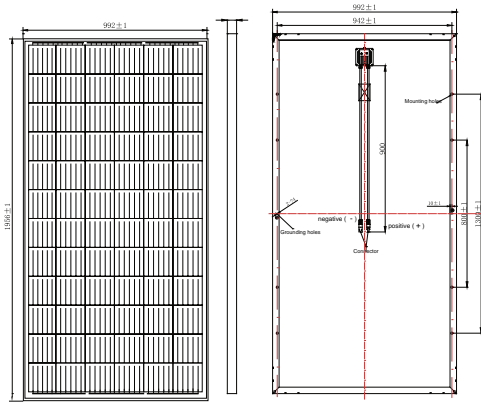

## ELECTRICAL DATA(STC)

Rated Power in Watts-Pmax(Wp)	330W
Open Circuit Voltage-Voc(V)	46.40
Short Circuit Current-Isc(A)	9.23A
Maximum Power Voltage-Vmp(V)	37.8V
Maximum Power Current-Imp(A)	8.74A
Module Efficiency (%)	17.01%

STC: Irradiance 1000 W/m<sup>2</sup>, Cell Temperature 25°C, Air Mass AM1.5 according to EN 60904-3.

## ELECTRICAL DATA(NOCT)

Maximum Power-Pmax (Wp)	246.46W
Open Circuit Voltage-Voc (V)	43.48V
Short Circuit Current-Isc (A)	7.46A
Maximum Power Voltage-Vmp(V)	35.20V
Maximum Power Current-Imp(A)	7.00A

NOCT: Irradiance at 800 W/m<sup>2</sup>, Ambient Temperature 20°C, Wind Speed 1 m/s.

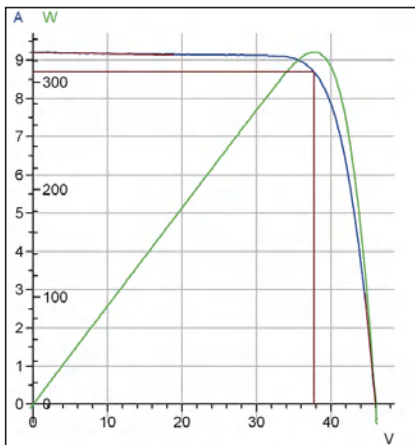
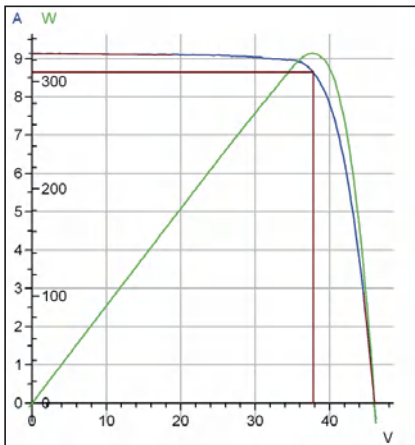

## MECHANICAL DATA

Solar cells	Polycrystalline 156.75 x 156.75mm, 5 Bus bars
Cell configuration	72 cells(6x12)
Module dimensions	1956 x 992 x30mm
Weight	20.5GS
Front Cover	3.2mm Tempered Glass
Frame Material	Anodized Aluminum Alloy
J-BOX	IP67
Cable	4mm <sup>2</sup> (IEC)/12AWG(UL),900mm
Connectors	MC4 or MC4 Comparable
Standard Packaging	36pcs/pallet

## TEMPERATURE & MAXIMUM RATINGS

Nominal Operating Cell Temperature (NOCT)	45°C±2°C
Temperature Coefficient of Voc	-0.32%/°C
Temperature Coefficient of Isc	0.05%/°C
Temperature Coefficient of Pmax	-0.39%/°C
Operational Temperature	-40~+85°C
Maximum System Voltage	1000V(IEC)/600V(UL)
Max Series Fuse Rating	15A
Limiting Reverse Current	15A

## PACKAGING CONFIGURATION

	40HQ
Number of modules per container	960pcs
Package	36pcs/pallet,2pcs/carton box
Package Number	24pallets + 48carton boxes
Package Weight	
Package Dimension	1980*1120*1130mm/pallet 1980*1020*90mm/carton box

A: No.99, Zhidong Road, Zhixi Town, Jintan District, Changzhou City, Jiangsu Province, China

T:+86 512-66292101  
W:www.resunsolar.com E:info@resunsolar.com